

Features:

Long electrical life cycles.
Choice of multiple colored caps.
Choice of painted colored caps.
Laser marking service.

产品特点:

提供带触感型及无触感型两种选择
超高亮OLED照光,耐久鲜明
高信耐接触,彩屏显示模式

Applications

Studio equipment.
Audio/Video products.
Broadcast system.
Instrumentation,
Telecommunications...etc.

使用范围

音响、影像等录音室器材设备
广播系统、电信仪器设备。

視覺切换

Visual switch



色泽均匀
Uniform color and luster



OLED照光颜色丰富, 耐久鲜明

Durable and vivid OLED display



高信耐接触, 彩屏显示模式

无杂讯



安静无声
Silent operation

General Specifications: (产品规格)

DISPLAY MODE:PASSIVE MATRIX.
DISPLAY COLOR:65,536 COLORS(MAXIMUM)
DRIVE DUTY:1/64 DUTY
RESOLUTION:64(RGB)X64
ACTIVE AREA:10.73X10.73
PIXEL PITCH:0.056X0.168
PIXEL SIZE:0.034X0.143
MODULE SIZE:15X32.66X1.2
PANEL SIZE:15X17.5X1.2 INCLUDING “ANTI-GLARE POLARIZER”

Material: (产品材质)

Cover: Polycarbonate(PC)
Actuator:Polyoxymethylene(POM)
Base frame:Polyamide(PA)+GF
Terminal:Brass with gold plating
Moving Contact:Phosphor bronze with gold plating

Terminal's Configuration

PIN 1	N.C.(GND)[Reserved pin (Supporting pin)]
PIN 2	VCC[Power Supply for oel panel]
PIN 3	VCOMH[Voltage Output High Level for COM Signal]
PIN 4	SDIN[Serial Data Input Signal]
PIN 5	SCLK[Serial Clock Input Signal]
PIN 6	D/C#[Data/Command Control]
PIN 7	RES#[Power Reset for Controller and Driver]
PIN 8	CS#[Chip Select]
PIN 9	IREF[Current Reference for Brightness Adjustment]
PIN 10	VDD[Power Supply for Core Logic Circuit]
PIN 11	VSS[Ground of logic Circuit]
PIN 12	N.C.(GND)[Reserved Pin(Supporting Pin)]

HOW TO ORDER

SERIES	OPERATION	ACTUATION TYPE	DISPLAY	PIXEL	INTERFACE	FRAME TYPE	CAP COLOR	PLATE COLOR
DSP3	N	X	F	A	S	A	T	F
	N=NON-LOCK	T=TACTILE TYPE N=NON TACTILE X=NON OPERATION	W=WHITE F=FULL COLOR	A=64X64[0.6寸]	S=SPI	A=13.8 TYPE [H=13.8] B=16 TYPE [H=16] C=18 TYPE [H=18]	T=TRANSPARENT KT=BLACK TRANSPARENT RT=RED TRANSPARENT GT=GREEN TRANSPARENT BT=BLUE TRANSPARENT YT=YELLOW TRANSPARENT OT=ORANGE TRANSPARENT WT=WHITE TRANSPARENT N=NONE	F=FILM PLATE[BLACK] R=RED G=GREEN B=BLUE Y=YELLOW O=ORANGE W=WHITE

CAP Symbol:Please refer to cap selection for all available symbols on cap surface,and any customization is welcomed

SCHEMATIC

PIXET FORMAT

“64X64”

DISPLAY MOLD

“OLED”
[PASSIVE MAXTRIX]

“SPI”

TERMINAL'S VIEW

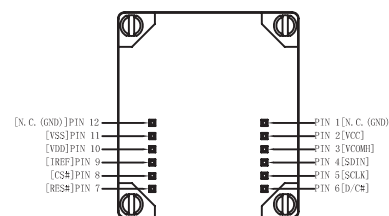

P.C.B LAYOUT

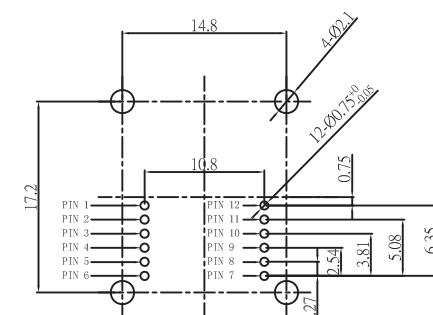



DSP3

■ LED ILLUMINATED PUSH BUTTON SWITCH

DSP3-NXFAS-AKTF

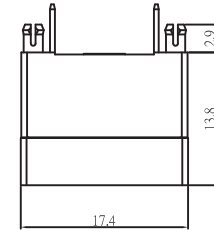
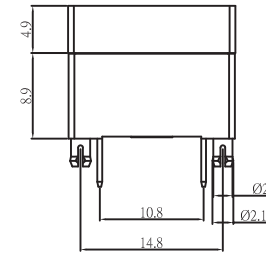
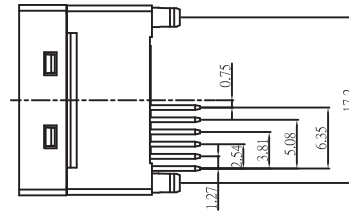
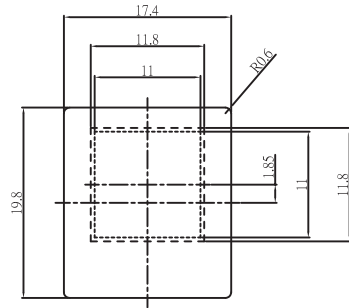

DSP3-NXFAS-AKTF

